

Fire Safety

- Fire extinguishing equipment should always be accessible.
- Access to exits, exit route or fire equipment or prop open stairwell doors shall be free of obstruction.
- Smoking is strictly prohibited inside building/ premises.
- Flammable liquid and combustible material shall be properly stored.

Bad Example:



Smoking is not allowed in workplace.



Fire extinguishing equipment shall be properly maintained.



Fire exit door shall never be obstructed.

Correct/ Good Practice:

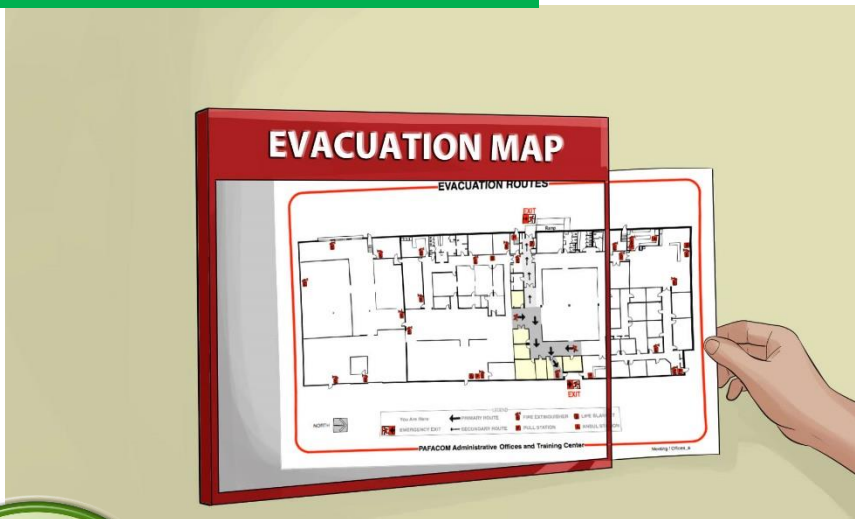





A fire evacuation route shall be planned and displayed in workplace.



Flammable substance shall be properly stored in safety cabinet.

Applications against different fire sources

Types of fire extinguishers	Water agent	Foam agent	Carbon dioxide	Dry powder agent
Categories of fires				
Category I: ordinary fire sources - paper, cloth, wood, plastic, etc.	✓	✓	✗	✓
Category II: flammable liquids or gases - solvents, fuels, LPG, etc.	✗	✓	✓	✓
Category III: Electrical appliances - motors, electricity switches, etc.	✗	✗	✓	✓

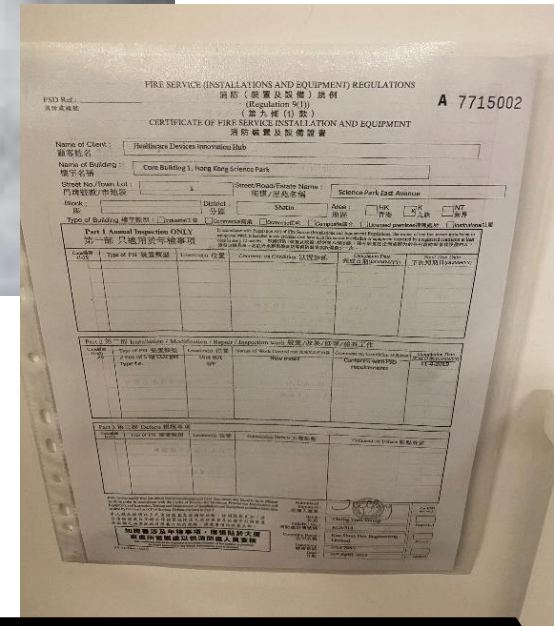

Proper fire extinguisher shall be used to put out different categories of fire.



Annual inspection shall be carried out for all firefighting equipment.



Refer to SHE Handbook for more information